

M3 Chassis

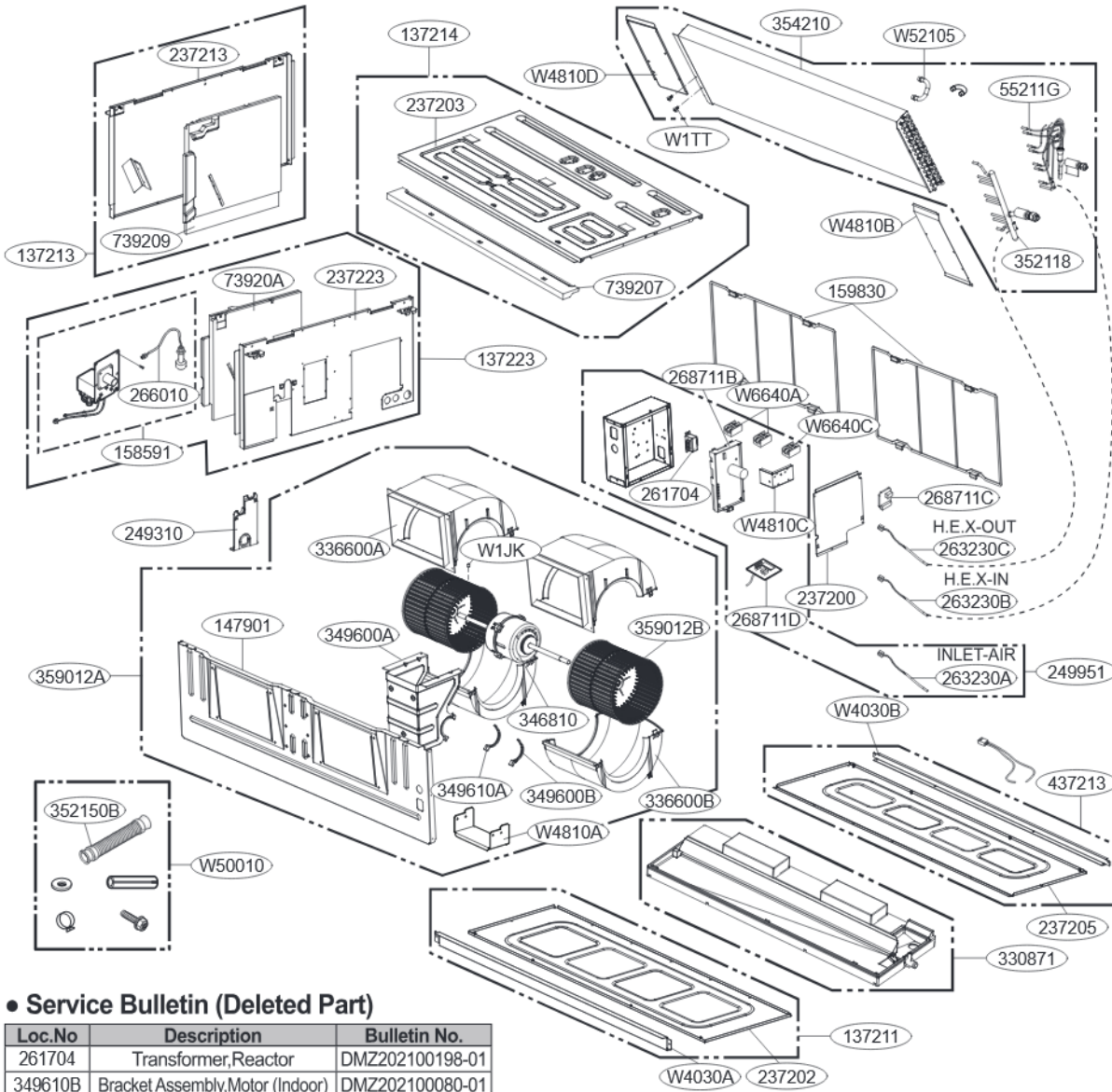

● Service Bulletin (Deleted Part)

Loc.No	Description	Bulletin No.
261704	Transformer, Reactor	DMZ202100198-01
349610B	Bracket Assembly, Motor (Indoor)	DMZ202100080-01

● Location 354210 Assembly

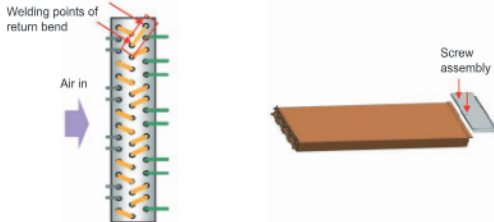

● Service Bulletin (For Suffix : ENCBLEU)

Loc.No	Part Description	Bulletin No.
268711B	PCB Assembly, Main	DMZ202500025-01 (For ARNU48/54GM3A4) DMZ202500024-01 (For ARNU18/24/28GM3A4)

● Location 354210 Required parts

Description	L/No.	Qty
Evaporator Assembly, First	354210	1
Tube, Return Bending	W52105	1
Bracket	W4810D	1
Screw, Tapping	W1TT	2
Tube Assembly, Return Bending	352119	15

Loc. No	Description	Remark (Color)
263230A	Thermistor for room air temperature	CN_ROOM (Yellow)
263230B	Thermistor for pipe in temperature	CN_PIPE_IN (White)
263230C	Thermistor for pipe out temperature	CN_PIPE_OUT (Red)
268711B	PCB for main	210 mm X 115 mm
268711C	PCB for option	25 mm X 25 mm
268711D	PCB for communication	65 mm X 45 mm