

6.1.4 18,20HP(UX3 3comp)

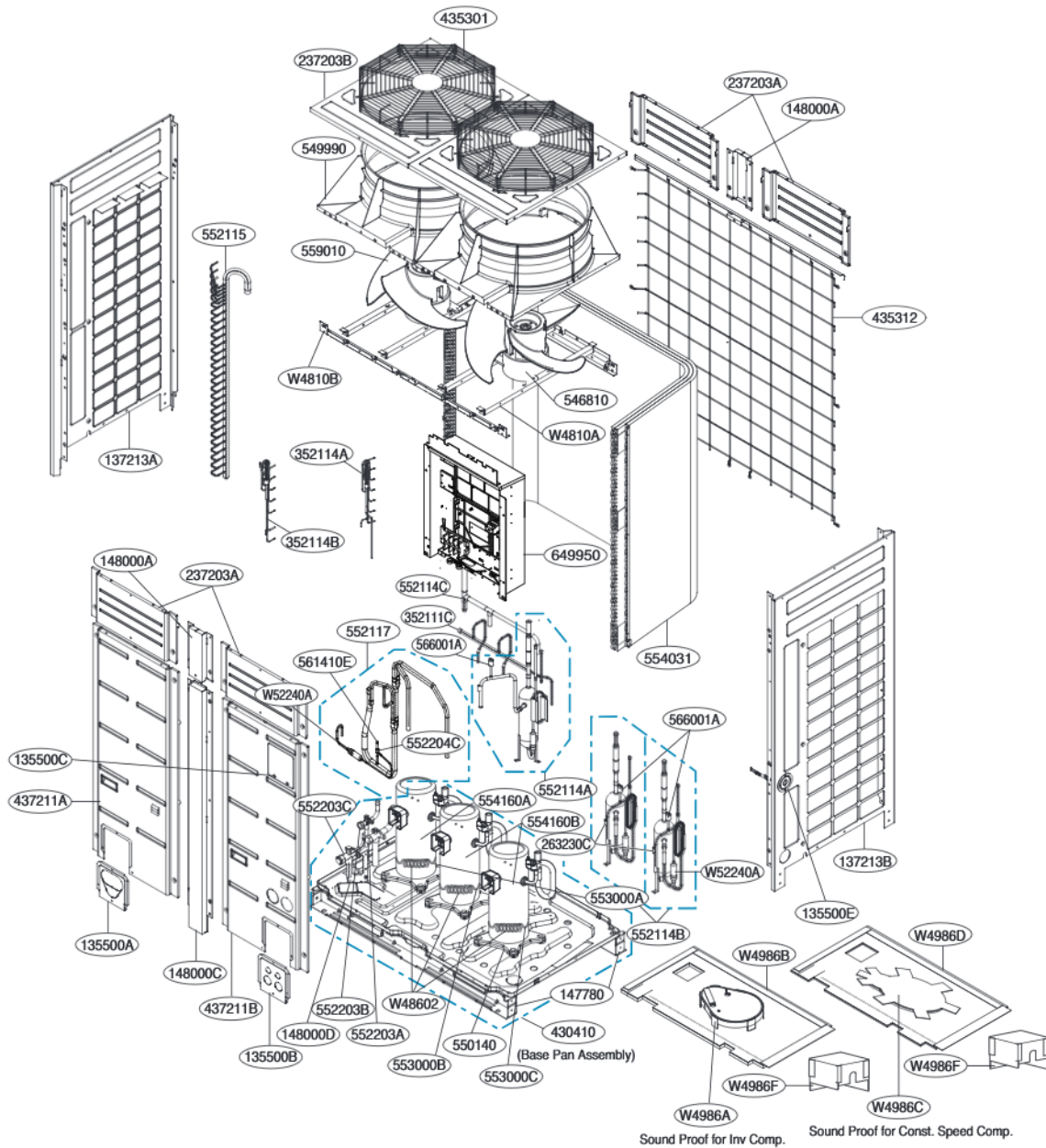

Fan	Normal Fan ADP35622801	Low noise Fan ADP73273801	L/No. 559010
Constant Compressor	Housing Type TBZ35376001	Screw Type TBZ35678701	L/No. 554160B
Fan Motor	LG(C&M) motor EAU60687201	Panasonic motor EAU43080001	L/No. 546810
Part	L/No.	Remark	
Inv Comp. Heater	553000A	Housing Color : Blue	
Const. Speed Comp. 1 Heater	553000B	Housing Color : Yellow	
Const. Speed Comp. 2 Heater	553000B	Housing Color : Orange	
Heater Spring	W48602	-	
Const. Speed Comp.1 Discharge + Const. Speed Comp.2 Discharge + Low HEX3 Temp. Senso	263230C	Housing Color : Black	

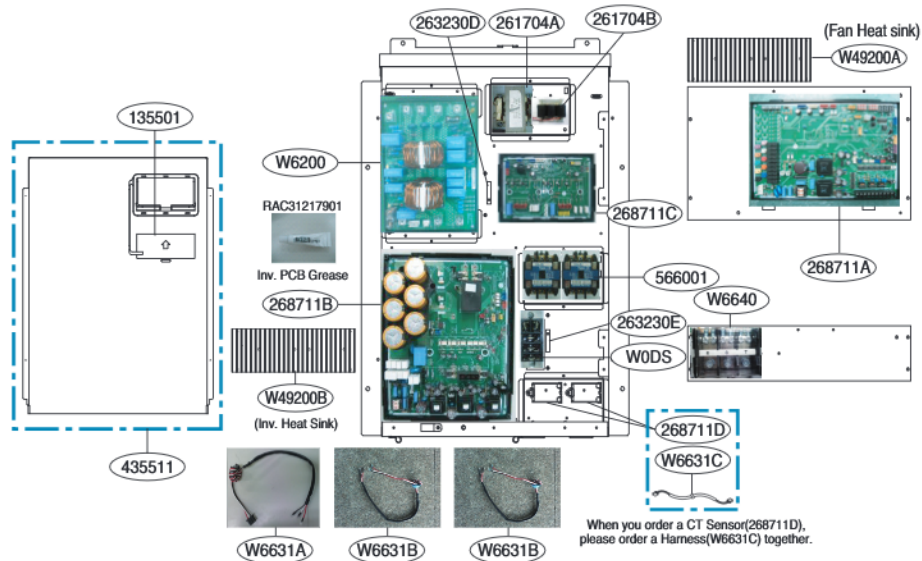
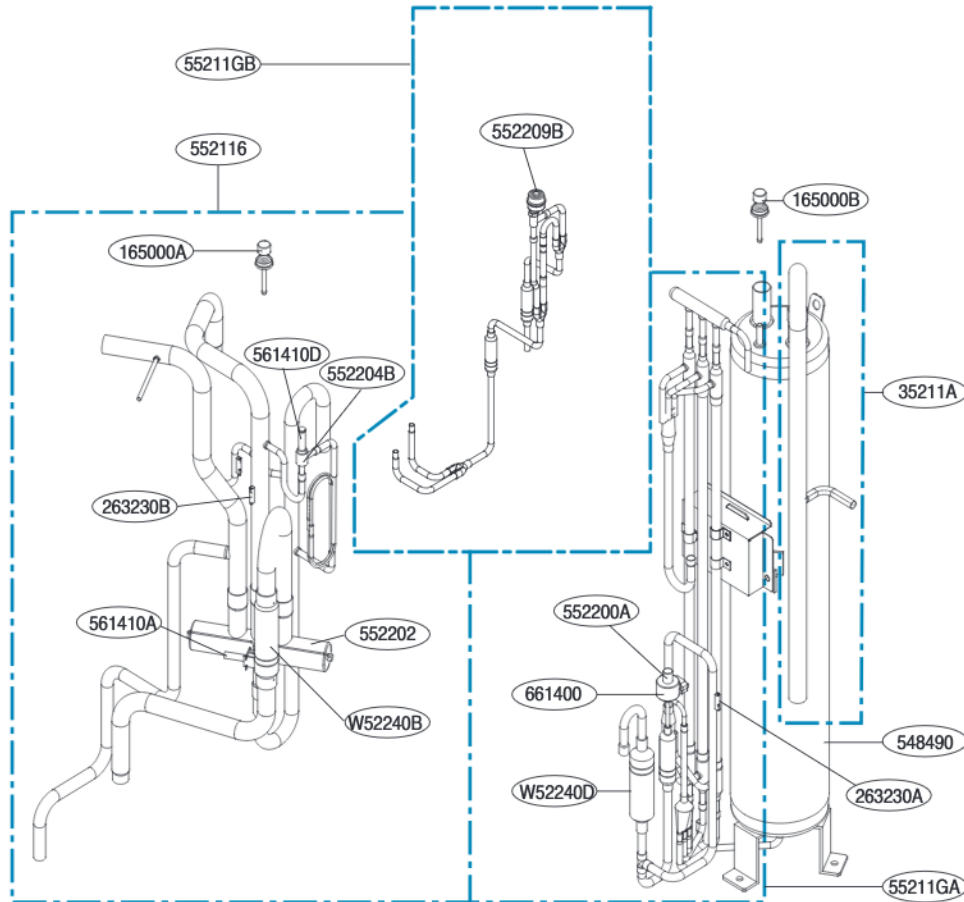

	Housing Type	Screw Type	L/No.
Constant compressor lead wire	EAD43354422	EAD62061405	W6631B
	LG(C&M) motor	Panasonic motor	L/No.
Fan PCB	EBR34853112	EBR34853102	268711C
Part	L/No.	Sensor location	Remark
Temp. Sensor 1	263230A	Sub Cool Out + HEX2(Upper Temp. Sensor) + Liquid Pipe	Housing Color : Yellow
Temp. Sensor 2	263230B	Suction Pipe + HEX1(Temp. Sensor) + Inv. Discharge	Housing Color : Purple
Temp. Sensor 3	263230E	Air + Inv. IPM	Housing Color : Green

