

- Heat Pump Model : ARUN100LT2, ARUN120LT2, ARUN140LT2, ARUN160LT2
- Cooling Only Model : ARUV120LT2(E), ARUV140LT2(E), ARUV160LT2(E)

UW 1

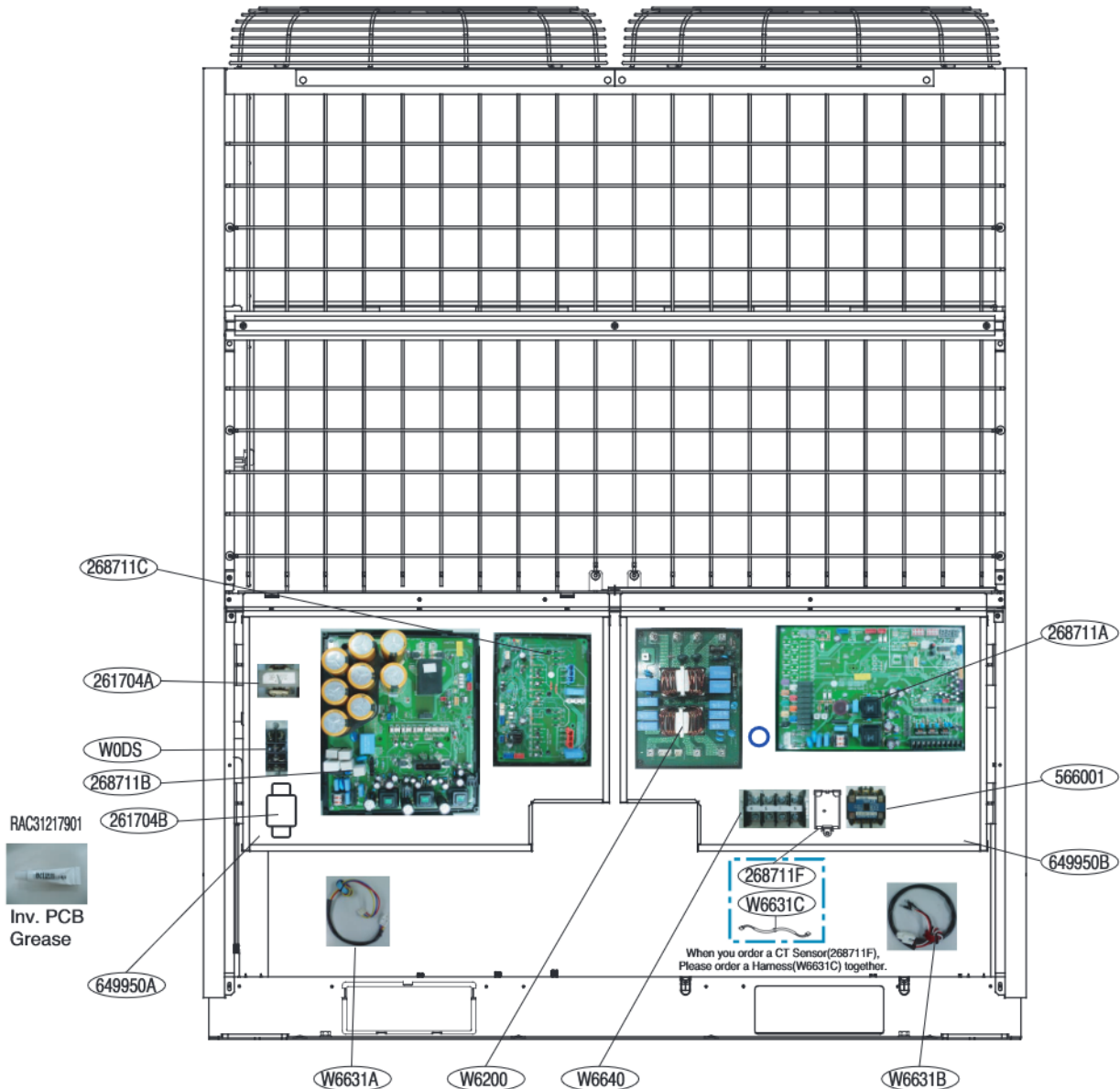

* Before replacing INV control box or Fan motor PCB,
Please check Part Number.
There are two Part Number.

■ INV control box (Location Number : 649950A)

Model	Production	Panasonic Motor Model ~ 2010.4	LG Motor Model 2010.5 ~
ARUN100LT2		ABQ34394904	ABQ34394313
ARUN120LT2			ABQ34394313
ARUN140LT2			ABQ34394313
ARUN160LT2			ABQ34394313
ARUV120LT2(E)			ABQ34394313
ARUV140LT2(E)			ABQ34394313
ARUV160LT2(E)			ABQ34394313

■ Fan motor PCB (Location Number : 268711C)

Model	Production	Panasonic Motor Model ~ 2010.4	LG Motor Model 2010.5 ~
ARUN100LT2		EBR34853106	EBR34853105
ARUN120LT2			
ARUN140LT2			
ARUN160LT2			
ARUV120LT2(E)			
ARUV140LT2(E)			
ARUV160LT2(E)			

* After May , 2010 , Multi V Plus II use LG motor (New).

• Heat Pump Model
 - ARUN100LT2, ARUN120LT2, ARUN140LT2, ARUN160LT2

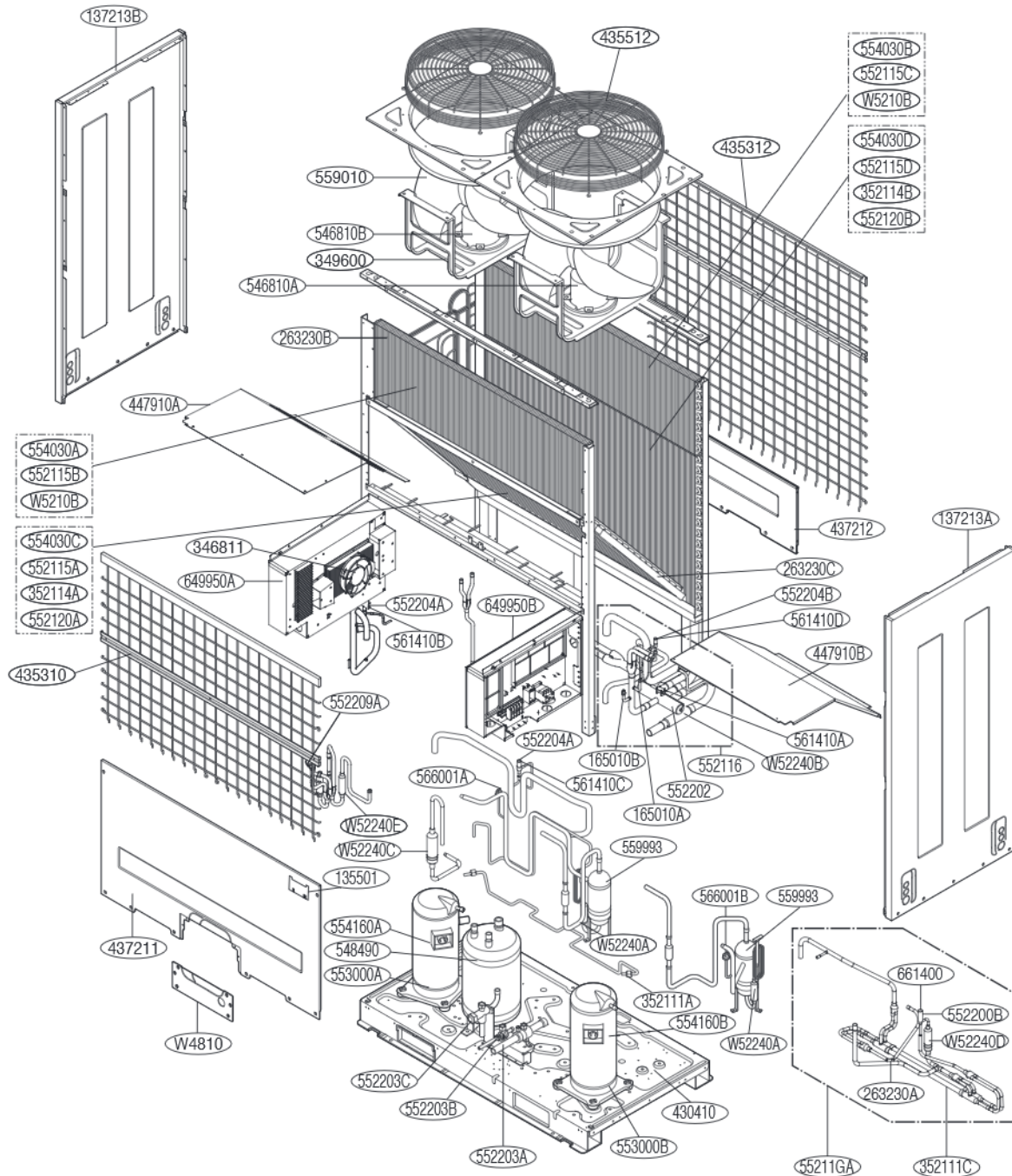

THERMISTOR 1	263230A	Liquid Pipe + sub Cooler IN + Sub Cooler OUT	Housing color : yellow
THERMISTOR 2	263230B	Inv. discharge + HEX(Front) + HEX (back)	Housing color : purple
THERMISTOR 3	263230C	Air + suction Pipe + const. Discharge Pipe	Housing color : black

■ Fan motor (Location Number : 546810A,546810B)

Production Model	Production	Panasonic		LG	L/No
	~ 2010.4	2010.5 ~			
ARUN100LT2	EAU43475201	Right	2010.5 ~		546810A
ARUN120LT2					
ARUN140LT2		Left			546810B
ARUN160LT2					

※ Before replacing fan motor, Please check fan motor maker.
 ※ Panasonic Motor (Part Number : EAU43475201) is the obsolete part. Please replace Panasonic Fan Motor with LG Fan Motor (Part Number : EAU36301603, EAU36301604) and LG Fan Motor PCB.

