

6.1.2 10,12,14Hp(UX3 2 COMP, 460V, 60Hz)

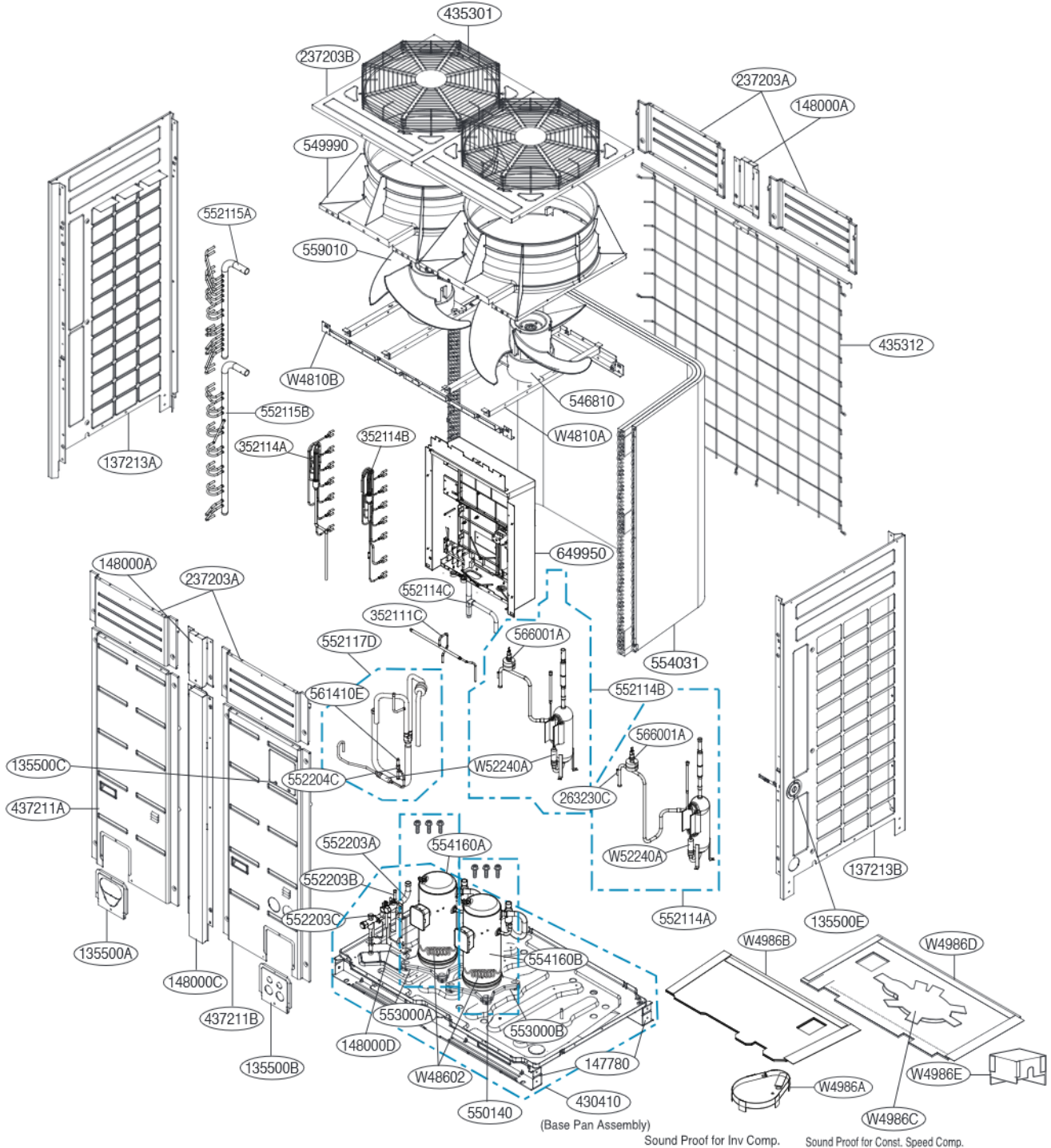

Part	L/No.	Remark
Inv Comp. Heater	553000A	Housing Color : Blue
Const. Speed Comp. Heater	553000B	Housing Color : Yellow
Heater Spring	W48602	-
Const. Speed Comp. Discharge + Low HEX3 Temp. Sensor	263230C	Housing Color : Black

Exploded view

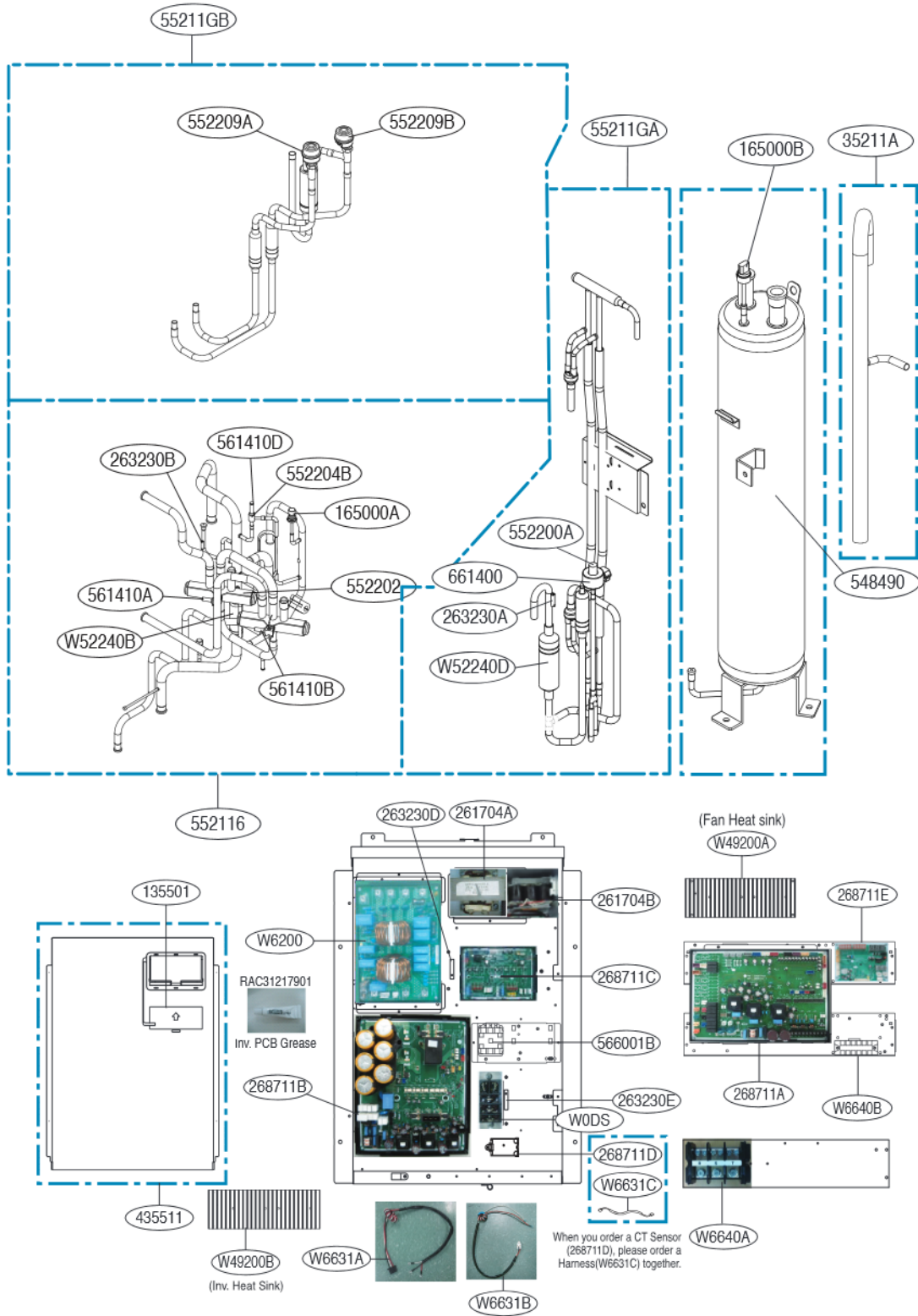

Part	L/No	Sensor location	Remark
Temp. Sensor 1	263230A	Sub Cool Out + HEX2(Upper Temp. Sensor) + Liquid Pipe	Housing Color : Yellow
Temp. Sensor 2	263230B	Suction Pipe + HEX1(Temp. Sensor) + Inv. Discharge	Housing Color : Purple
Temp. Sensor 3	263230D	Fan Heat sink	Housing Color : white
Temp. Sensor 4	263230E	Air + Inv. IPM	Housing Color : Green

